



URBAN DISTRICT 30

Urban District 30 is a 5-building, 977,013-square-foot Class A industrial development strategically located directly off Interstate 30 in the Northeast Dallas-Garland-Mesquite submarket. Located 12-miles from Dallas' CBD, the project has access to one of the strongest labor sources in the Dallas/Fort Worth metroplex.



[CLICK BUILDINGS FOR DETAILS](#)



BUILDING 1



BUILDING 1
177,473 SF

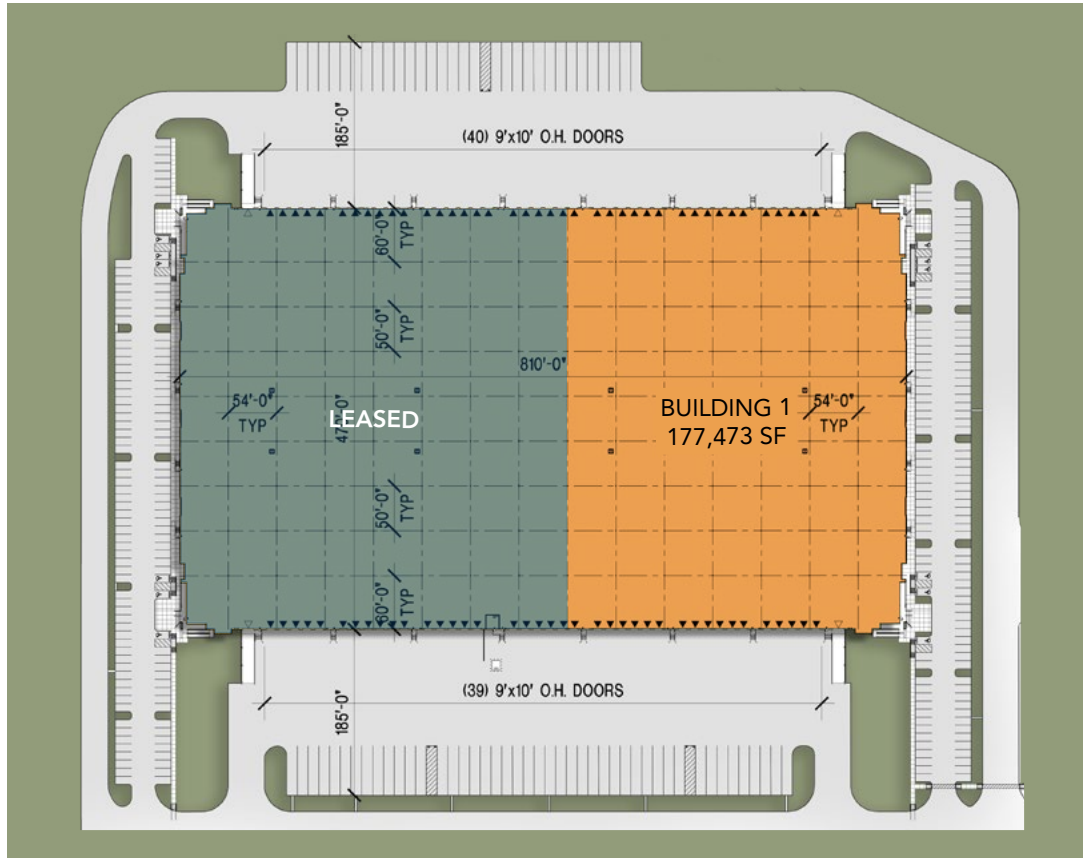

BUILDING 1

Available SF (Divisible):	177,473 SF
Dimensions:	470' d x 810' w
Office SF:	BTS
Loading:	Cross Dock
Clear Height:	36'
Sprinkler:	ESFR
Dock Doors:	36 (9' x 10')
Ramp Doors:	2
Trailer Parking:	27
Car Parking:	138
Column Spacing:	54' x 50'
Staging Bay:	60'
Warehouse Lighting:	LED
Dock Levelers:	BTS
Truck Court:	185'

[RETURN TO HOME](#)



MATT DORNAK, SIOR
mdornak@streamrealty.com
214-267-0461

BLAKE KENDRICK
bkendrick@streamrealty.com
214-267-0472



BUILDING 2



BUILDING 2
129,473 SF

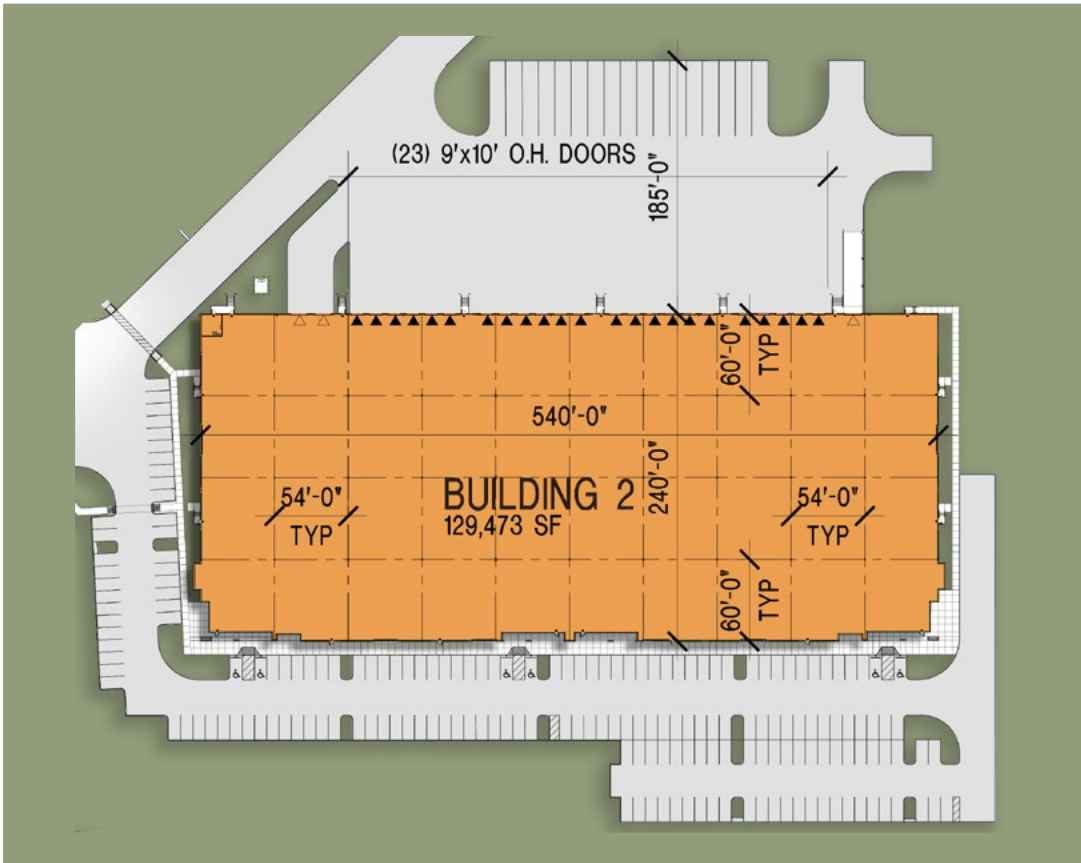

BUILDING 2

Available SF (Divisible):	129,473 SF
Dimensions:	240' d x 540' w
Office SF:	BTS
Loading:	Rear Load
Clear Height:	28'
Sprinkler:	ESFR
Dock Doors:	23 (9' x 10')
Drive-in Doors:	3
Trailer Parking:	17
Car Parking:	189
Column Spacing:	54' x 60'
Staging Bay:	60'
Warehouse Lighting:	LED
Dock Levelers:	BTS
Truck Court:	185'

[RETURN TO HOME](#)

BUILDING 3



BUILDING 3
169,924 SF

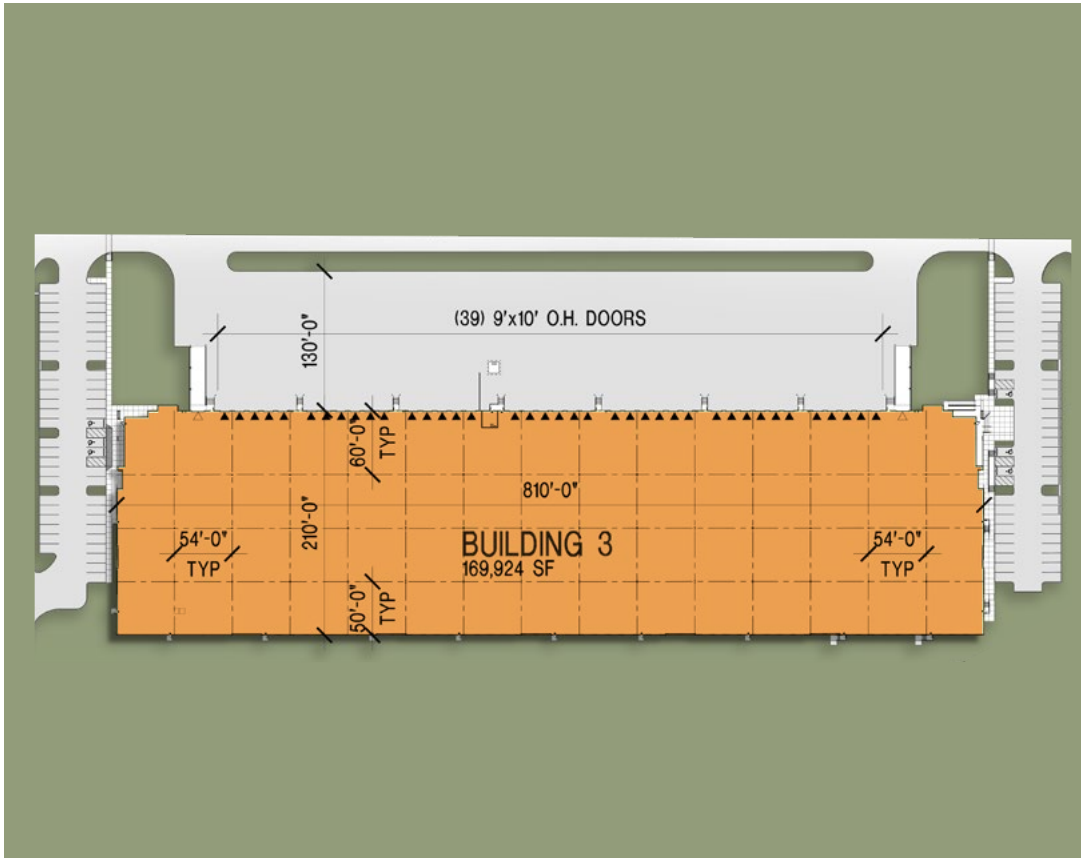

BUILDING 3

Available SF (Divisible):	169,924 SF
Dimensions:	210' d x 810' w
Office SF:	BTS
Loading:	Front Load
Clear Height:	32'
Sprinkler:	ESFR
Dock Doors:	39 (9' x 10')
Ramp Doors:	2
Trailer Parking:	0
Car Parking:	102
Column Spacing:	54' x 50'
Staging Bay:	60'
Warehouse Lighting:	LED
Dock Levelers:	BTS
Truck Court:	130'

[RETURN TO HOME](#)

BUILDING 4



BUILDING 4
138,402 SF

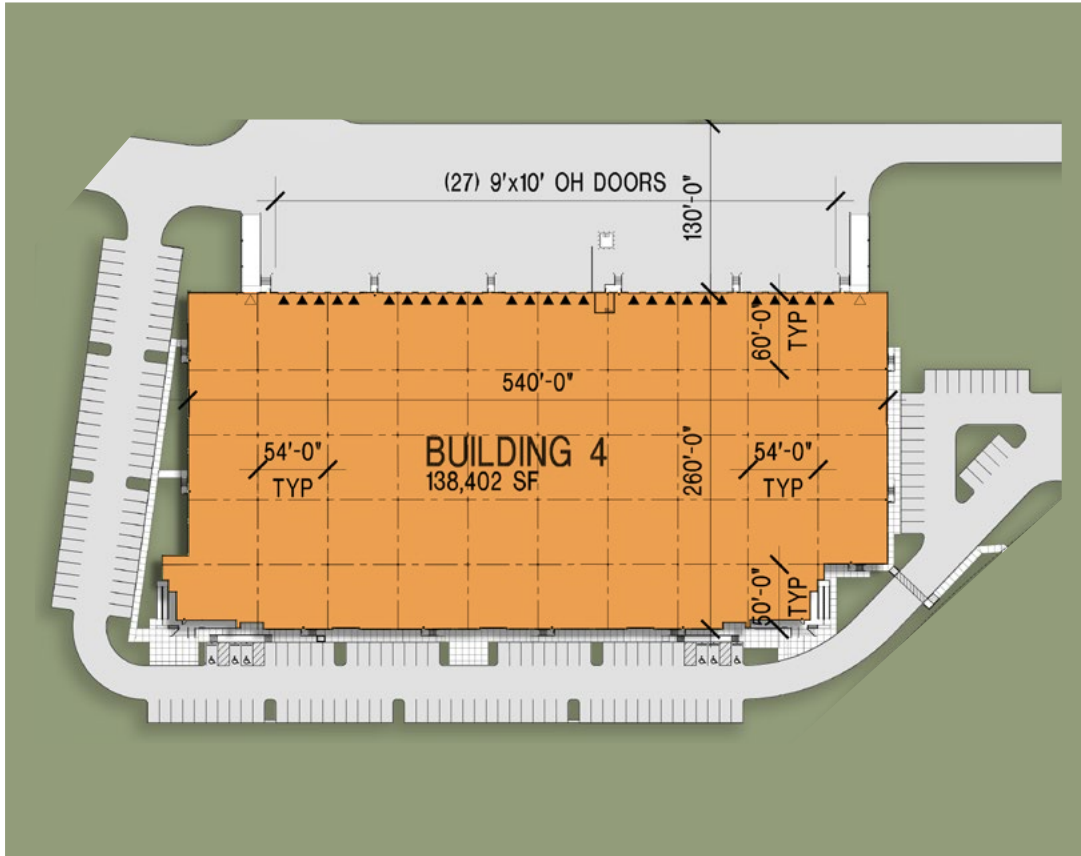

BUILDING 4

Available SF (Divisible):	138,402 SF
Dimensions:	260' d x 540' w
Office SF:	BTS
Loading:	Rear Load
Clear Height:	28'
Sprinkler:	ESFR
Dock Doors:	27 (9' x 10')
Ramp Doors:	2
Trailer Parking:	0
Car Parking:	173
Column Spacing:	54' x 50'
Staging Bay:	60'
Warehouse Lighting:	LED
Dock Levelers:	BTS
Truck Court:	130'

[RETURN TO HOME](#)

BUILDING 5



BUILDING 5
158,701 SF

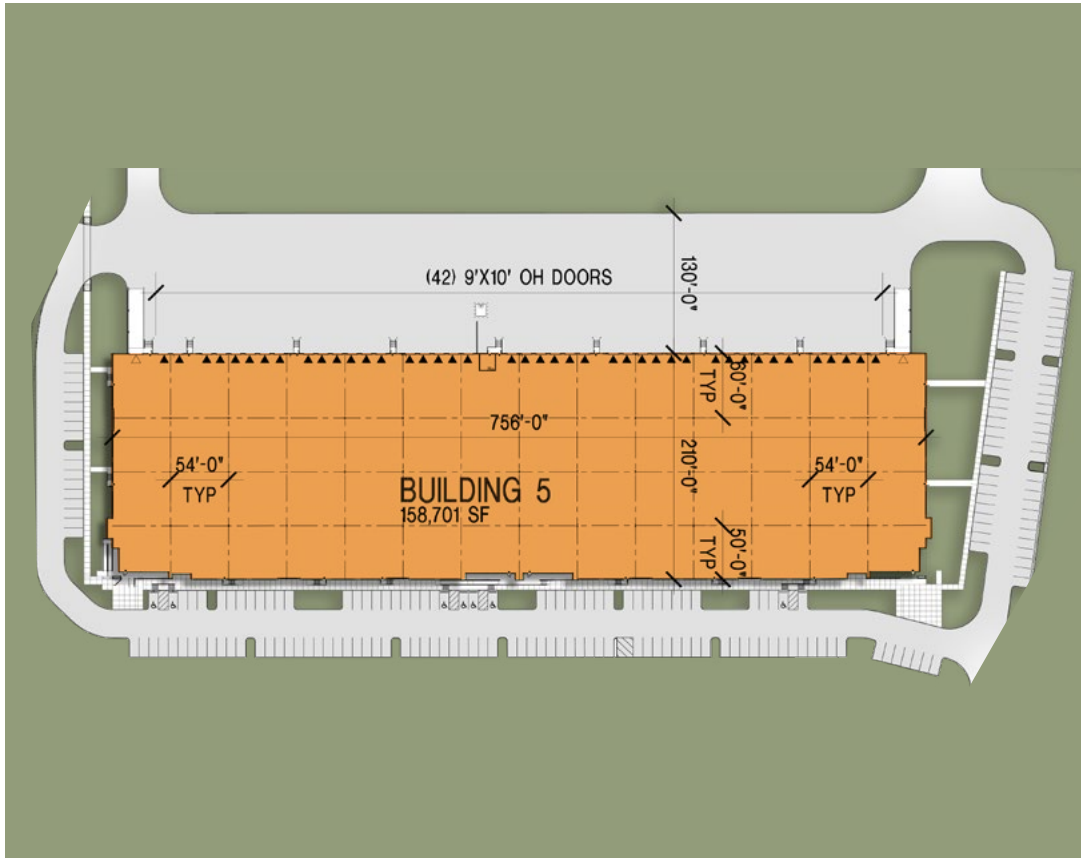

BUILDING 5

Available SF (Divisible):	158,701 SF
Dimensions:	210' d x 756' w
Office SF:	BTS
Loading:	Rear Load
Clear Height:	28'
Sprinkler:	ESFR
Dock Doors:	42 (9' x 10')
Ramp Doors:	2
Trailer Parking:	0
Car Parking:	204
Column Spacing:	54' x 50'
Staging Bay:	60'
Warehouse Lighting:	LED
Dock Levelers:	BTS
Truck Court:	130'

[RETURN TO HOME](#)



MATT DORNAK, SIOR
mdornak@streamrealty.com
214-267-0461

BLAKE KENDRICK
bkendrick@streamrealty.com
214-267-0472

